

FULHAM ROAD

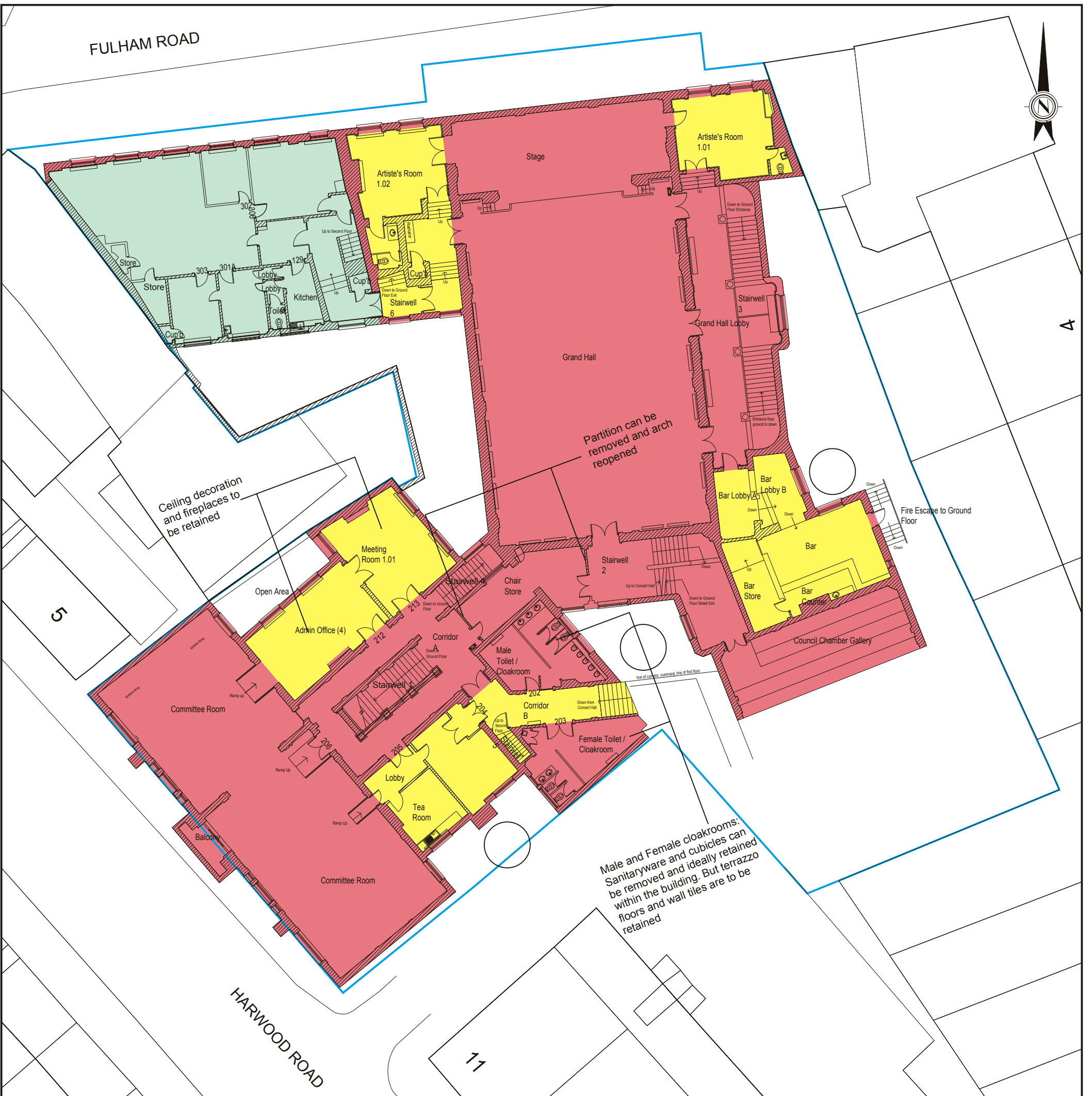

KEY

- Areas of high significance in terms of architectural quality and / or historic interest where proposed alterations that adversely affect that significance would be wholly exceptional
- Areas of some significance in terms of architectural quality and / or historic interest where proposed alterations that adversely affect that significance would be exceptional
- Areas of low significance in terms of architectural quality and / or historic interest
- Potential zones for new lift shafts to be installed
- Site Boundary

NOTE: Based upon drawing no. 1296_DWG_00_801 Rev P1, produced by Hawkins/Brown, April 2011

HAMMERSMITH AND FULHAM COUNCIL
 Transport & Technical Services
 Town Hall Extension, King Street
 London W6 9JU
 Tel. 020 8748 3020

Drawn	Checked	Approved
CEP	-	-
Scale	Original Sheet Size	
Not To Scale	A3	
DWG No.	Revision	Date
31153/6/2	A	Sep.'12

PROJECT

**FULHAM TOWN HALL
 HERITAGE ASSESSMENT**

AREAS OF SIGNIFICANCE

EXISTING FIRST FLOOR PLAN

DRAFT & UNCHECKED 25/9/2013

NOTES
 Key and title changed

Date	Rev	Init
Apr. '13	A	CEP

© Crown copyright and database rights
 2012 Ordnance Survey Licence No. LA100019223

Devised and created by the Land & Asset Survey Team using CAD & GIS software. This drawing is Copyright.



FS 32265